

# Performance of Helix vs. Rebar

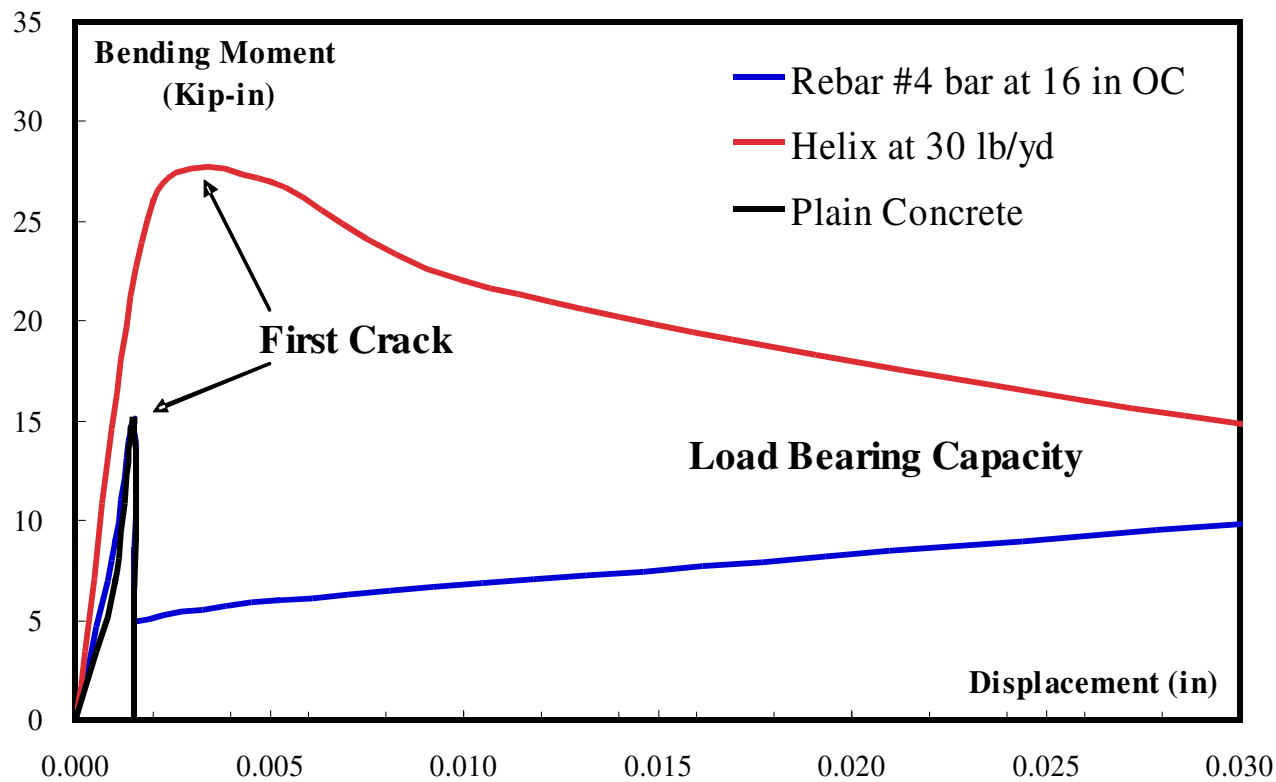

16" thick concrete slab	Crack Resistance (kip-inches)	Structural Capacity (kip-inches)
Plain Concrete	1484	0
#6 @ 9" T&B with 6-6-6-6 WWF	1484	522
<b>Helix @ 50 lbs/yd<sup>3</sup></b>	<b>2706</b>	<b>555</b>